

## How to Install Custom Cellular Accordia Shades

Before you begin your installation:

### READ ALL INSTALLATION INSTRUCTIONS!

- Make sure that you have all tools and hardware needed for installation.
- Check the installation surface (wall, ceiling, or window frame) to ensure that you have suitable fasteners and tools for the material.
- Double check the headrail and shade for proper width and length. If you are installing several sets of shades, be sure to match them with the appropriate window.
- Check the parts list shipped with the product to confirm that you have the correct number of brackets.

### TOOLS YOU MAY NEED (NOT INCLUDED):

- Phillips head screwdriver
- Pencil
- Level
- Tape measure
- Safety glasses
- Drill/drill bits (1/16" drill bit may be used to pre-drill for screws)
- Wrench (if using extension brackets)
- 1/4" Hex nutdriver (optional for mounting screws)
- Drywall anchors

### MOUNTING BRACKETS:

Two mounting screws needed per bracket.

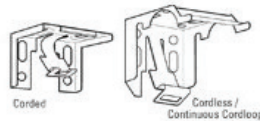

### OPTIONAL BRACKETS:

#### Extension Brackets

(Offers clearance for obstructions) Outside mounting extension brackets will provide 1"–3" clearance between the headrail and mounting surface. Assemble extension bracket as shown. Secure an extension bracket to each standard mounting bracket.



#### Hold-Down Brackets

(Eliminates Sway) Ideal for doors, hold-down brackets prevent shade from swaying. Assemble as shown to each side of bottomrail.

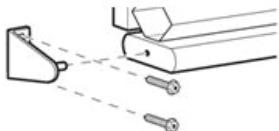

#### Spacers

Outside mounting spacers will provide an additional 3/8" clearance as shown. If spacers are used, longer screws may be required to ensure a secure installation. Utilize one spacer behind each bracket.



#### Side-Mount Brackets

(Ideal for windows below transoms and arches) Alternative mounting method when no frame is available above the window for mounting. Use only if shade dimensions fall within 6" W × 6" L (corded) or 12" W × 12" L (cordless) to a maximum of 48" W × 72" L.

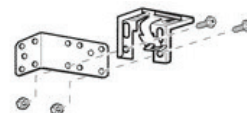

## STEP 1A

Mark the bracket locations — outside mount installation (installation outside window casing)

- Measure headrail width.
- End brackets should be approximately 1"–2" in from each end of the headrail. Space any remaining brackets evenly across the headrail, no more than 30" apart — motor location on cordless.

**NOTE: Ensure that bracket placement will not interfere with any components inside the headrail.**

- With a pencil, mark the mounting screw locations through the rear holes of the bracket, 2 per bracket. Use a level to ensure bracket alignment.
- Go to Step 2A.

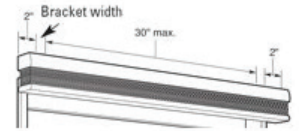

## STEP 2A

Install the brackets — outside mount installation (installation outside window casing)

- Using pencil marks as a guide, start the screw hole by pre-drilling (wood and metal mounting surfaces only).
- Hold bracket with surface marked "top" facing up. Holding bracket in place, secure with screws, 2 per bracket.
- Repeat for each bracket.
- Use a level to confirm brackets are level.

Example: Installation on drywall using drywall anchors and included screws.

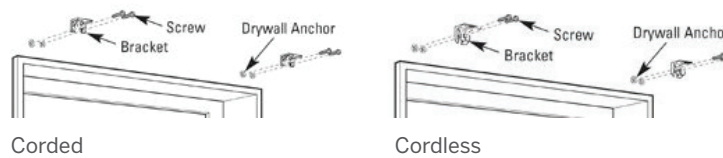

## STEP 1B

Mark the bracket locations — inside mount installation (installation inside window casing)

- Verify that window casing has a minimum depth of 5/8" for corded and 1/2" for cordless shades
- Place the bracket on the inside top of the window frame, 1"–2" in from the ends. Space any remaining brackets evenly across the proposed headrail location, no more than 30" apart.
- If flush mount is desired, place the bracket 2-1/4" back from the inside top of the window frame.
- With a pencil, mark the drill hole locations through the tip holes of the bracket, 2 per bracket.
- Go to step 2B

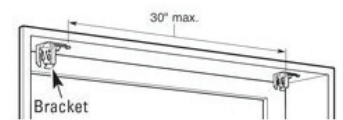

## STEP 2B

Install the brackets - inside mount installation (installation inside window casing)

- Using pencil marks as a guide, start the screw hole by pre-drilling (wood and metal mounting surfaces only).
- Hold bracket with surface marked "top" facing up. Holding bracket in place, secure with screws, 2 per bracket.
- Repeat for each bracket.
- Make sure brackets are square with each other.

Example: Installation on a wood window frame using the included screws.



## STEP 3A

Install shade on brackets

### Corded Shades/Angles/Specialty Shapes

- Hook the rear lip of the headrail on the mounting bracket spring tab.
- While pushing back against the bracket, rotate the front of the headrail upward to engage the top locking tab of the mounting bracket. The shade will easily snap onto the bracket.
- **CAUTION:** Be sure the bracket and headrail are properly secured before operating the shade.
- To remove the shade: While pushing back on the headrail, rotate the front of the headrail down. Never force the spring tab beyond the back of the bracket.
- **See 3B for installing cordless shades or continuous cordloop shades**

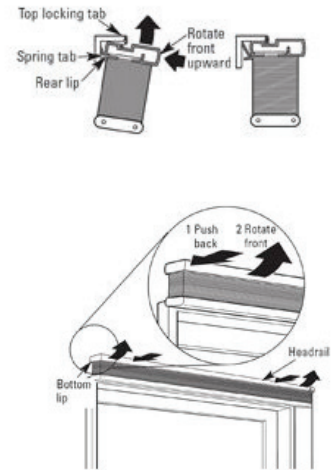

## STEP 3B

Install shade on brackets

### Cordless/Continuous Cordloop Shades

- Hang the curved front side of the headrail on front lip of brackets.
- Rotate headrail backward toward window until a snapping sound is heard. This will let you know that the shade is engaged into brackets.
- **CAUTION:** Be sure that the bracket and headrail are properly secured before operating the shade.
- Use included hex-head screw (#8 X 1-1/4" long) to secure the shu-clip (attached to cordloop) to mounting surface, ensuring that the cordloop is taut.
- To remove headrail from bracket: Insert flat head screwdriver into square opening on bracket tab. Push backward to disengage tab from headrail.

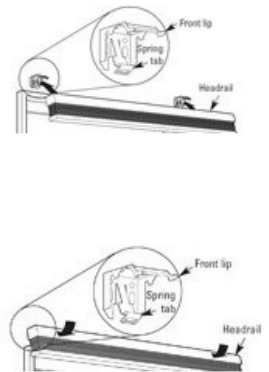

## STEP 4

Install decorative drapery hardware valance (optional)

- Hook the valance on the front of the headrail and rotate downward until all snaps engage under the headrail.
- Screw the finials into the holes at each end of the valance.

